

B. L. REALTY (INDIA) PVT. LTD.

Madhusudon Pramanik
Managing Director

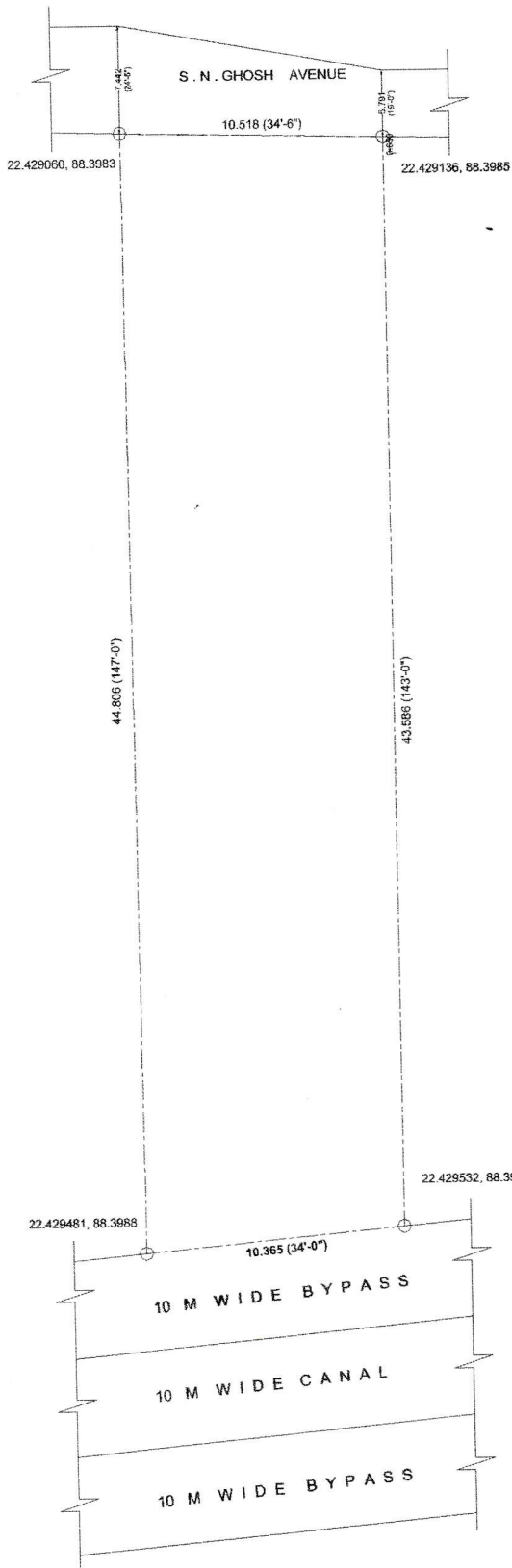
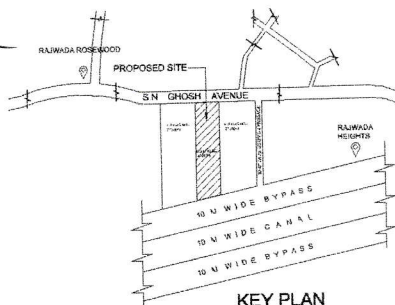

SITE PLAN
SCALE=1:1

NOTES

1. ALL DIMENSIONS ARE IN M. (UNLESS OTHERWISE MENTIONED)
2. DEPTH OF THE FOUNDATION OF SEMI UNDERGROUND WATER RESERVOIR WILL NOT EXCEED THE DEPTH OF THE BUILDING FOUNDATION
3. ALL CHALLJAS ARE 0.900 M PROJECTED AND 0.150 M BEARING WITH EACH SIDE OF THE OPENING
4. ONLY WRITTEN DIMENSIONS ARE TO BE FOLLOWED.

SPECIFICATIONS

ALL EXTERNAL WALLS ARE 0.200 M THICK, EXCEPT OTHERWISE MENTIONED, CONSTRUCTION WITH CEMENT, SAND MORTAR (1:4)
 ALL PARTITION WALLS ARE 0.125 M & 0.075 M THICK, CONSTRUCTION WITH CEMENT SAND MORTAR (1:4)
 PLASTER = CEMENT, SAND (1:4), (1:6)
 FLOORING = TERRAZZO / CERAMIC TILES
 ROOF = R.C.C ROOF WITH WATER PROOFING MATERIALS.
 R.C.C = WITH CEMENT, SAND AND STONE CHIPS (1:2:4) (1:1.5:3), (1:1:2)
 P.C.C = PLAIN CEMENT CONCRETE WITH STONE CHIPS (1:3:6)
 STEEL = Fe 250
 CONCRETE = M25

DECLARATION OF OWNER

I DO HEREBY DECLARE WITH FULL RESPONSIBILITY THAT I SHALL ENGAGE L.B.A & E.S.E DURING CONSTRUCTION AND FOLLOW THE INSTRUCTION OF L.B.A & E.S.E DURING CONSTRUCTION OF THE BUILDING (AS PER DRAWING) AND IT IS CERTIFIED THAT I HAVE GONE THROUGH THE WEST BENGAL MUNICIPAL (BUILDING) RULES, 2007, AND ALSO UNDER TAKE TO ABIDE BY THOSE RULES DURING AND AFTER THE CONSTRUCTION OF THE BUILDING

MADHUSUDON PRAMANIK AS CONSTITUTED ATTORNEY OF

MANAGING DIRECTOR OF
 B.L. REALTY (INDIA) PVT. LTD.
 RESID. OFFICE:
 DHALLA NORTH, GHAKAL LANE,
 DEBRAJGHOSH ROAD,
 KOLKATA-700152

1) MONOTOSH NASKAR
 2) SANTU NASKAR
 3) ARATI NASKAR
 4) BABULAL NASKAR

MOBILE NO: 9051771478

SIGNATURE OF OWNER

CERTIFICATE OF STRUCTURAL ENGINEER

I/WE DO HEREBY CERTIFY THAT THE FOUNDATION AND SUPER STRUCTURE OF THE BUILDING PROPOSED FOR CONSTRUCTION AT HOLDING NO- 756, STREET - S.N. GHOSH AVENUE, WARD NO - 26, UNDER THE JURISDICTION OF RAJPUR-SONARPUR MUNICIPALITY HAVE BEEN PERSONALLY INSPECTED AND SO DESIGNED BY ME / US WILL MAKE SUCH FOUNDATION AND SUPER STRUCTURE SAFE IN ALL RESPECT INCLUDING THE CONSIDERATION OF BEARING CAPACITY AND SETTLEMENT OF SOIL, ALL POSSIBLE LOADS INCLUDING THE SEISMIC LOADS AND OTHER CONDITIONS, IF ANY, CONFORMING TO ALL SPECIFICATIONS OF ALL RELEVANT IS CODE OF PRACTICE AND NATIONAL BUILDING CODE OF INDIA.

NAME & ADDRESS OF G.T.E.:
 SUJIT KUMAR BOSE
 TAJU, SULTAN ALJAM ROAD,
 KOLKATA - 700033
 EMPANELLED NO:
 2818/R/S/ONG/1.E-1/2011
 MOBILE NO: 9846162660

NAME & ADDRESS OF E.S.E.:
 Koushik Sengupta
 S/O. BANAHATI PALACE,
 BRATI, KOLKATA - 700011
 EMPANELLED NO:
 KOL/P/S/ONG/2009-0302-243
 MOBILE NO: 9837938111

SIGNATURE OF G.T.E. SIGNATURE OF E.S.E.

DECLARATION OF ARCHITECT

I/DO HEREBY CERTIFY THAT PLANS, ELEVATIONS AND SECTIONS AND OTHER STRUCTURAL DETAILS OF THE PROPOSED BUILDING ON HOLDING NO- 756, STREET- S.N. GHOSH AVENUE, WARD NO - 26 UNDER THE JURISDICTION OF RAJPUR-SONARPUR MUNICIPALITY HAVE BEEN PREPARED IN CONFORMING WITH ALL RELEVANT PROVISIONS UNDER THE WEST BENGAL MUNICIPAL (BUILDING) RULES, 2007.

NAME OF ARCHITECT: DULAL MAZUMDER
COA REGISTRATION NO: CA / 96 / 19904
ENLISTMENT NO: 918 / RJP/SON/IBA/2019-20

SIGNATURE OF ARCHITECT

TITLE:
 SITE PLAN

PROJECT:
 PROPOSED (G+IV) RESIDENTIAL BUILDING NAMED B.L NABHOMANI AT S.N.GHOSH AVENUE, R.S DAG NO - 2131(PART), L.R DAG NO - 2177(P), R.S KHATIAN NO - 636, L.R. KHATIAN NO-2867,2868,2869,2870. MOUZA - ELACHI, J.L NO - 70, HOLDING NO - 756, WARD NO - 26, P.S - SONARPUR, DIST - SOUTH 24 PARGANAS, UNDER RAJPUR- SONARPUR MUNICIPALITY.

ARCHITECT: ART & ARCHITECTURE ARCHITECTS, ARTISTS, INTERIOR DESIGNERS, ENGINEERS FLAT NO - 01, DHRETI APARTMENT, BMC - 2346, SAHABAGAN, KOLKATA 700029 E-MAIL: info@artandarch.com@gmail.com PH - 7430 266797, 9402 221495	DRAWING NO: AANBHOJ/ARCHRSM - 01 SCALE: 1:1, UNIT: M DATED: 11-12-2022 DRAWN BY: N M CHECKED BY: D M
--	---

